

ARCHITEK ASSURED GREEN ROOFS
extensive + water retention

Shallow, light weight green roof that usually use sedums or shallow root grasses. The soil or grow media/substrate layer is usually shallower than 150 mm or 6" and the entire system has a saturated weight of less than 25 lbs. per square foot, average being about 20 lbs. per square foot. Among many benefits this green roof system is a low maintenance roof that requires no irrigation or minimal depending on specific climate.

KEY FEATURES:

Stormwater Management: Reduces the total volume and the rate of runoff, particularly during peak storm events.

Cost savings: Doubles roof life by protecting membrane from mechanical damage and UV exposure.

Improved Performance: Increased thermal insulation.

Reduced Heat Island: Moderates temperature so rooftop equipment (including solar PV) operates more efficiently.

Increased Value: Enhances views, creates enjoyable outdoor space and provides habitat for nature.

Locally Sourced Materials: Architek uses mostly locally sourced materials.

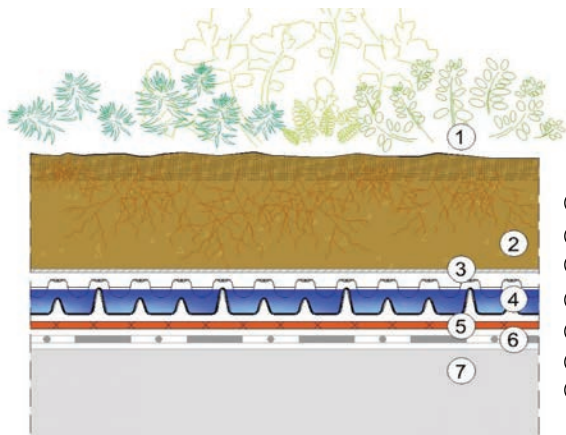
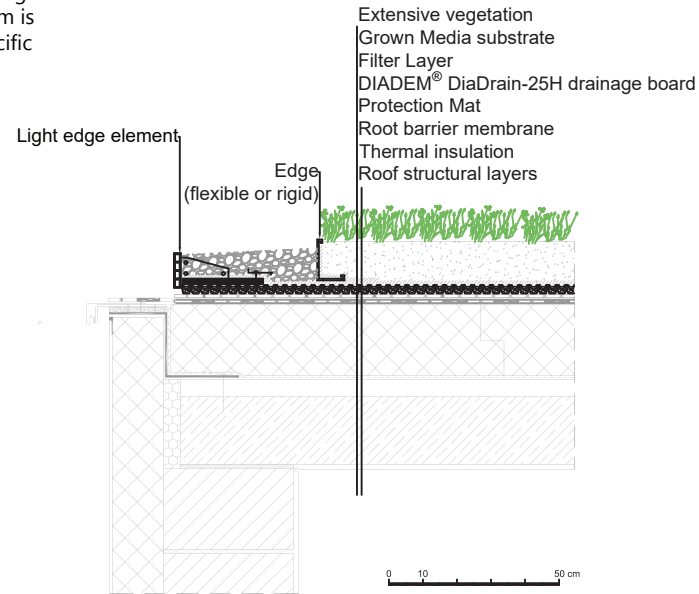

- ① EXTENSIVE VEGETATION
- ② GROWN MEDIA
- ③ DIADEM VLF 150/200 FILTER LAYER
- ④ DIADRAIN-25H
- ⑤ DIADEM VLU 300/500 MECHANICAL PROTECTION LAYER
- ⑥ ROOT RESISTANT WATERPROOFING MEMBRANE
- ⑦ ROOF STRUCTURE/CONSTRUCTION



Pre-grown vegetation mat.



DiaDrain-25H drainage board



Thickness of system (inch):	5.0"
Dry Weight (lbs/sqf):	12.59
Saturated Weight (lbs/sqf):	24.55
Vegetation (types):	Mix of Sedums / Plugs / Perennials
Water Retention capacity (L/sqm):	nearly 60

COMPONENTS:



Special plants for extensive green roofs. Sedums, plugs and perennials. Sedum size: 12" x 24" (different mixes). A coconut fiber base assures effective rooting of plants to the underlying growth medium and holds the tile together for easy installation.



Architek Extensive Mix. the proper blend of organic matter and aggregates to an FLL standard. The growing media ensures the nutrients needed for the growth of plants, serves as a support to the roots, thus providing the ground of the growth of the vegetation. It includes mostly minerals, mixtures with proper air content, and durable good water permeability and stable structure.

Available in bags and bulks.



Filter Layer. Geotextile is a filter layer with very low clogging indicator, allowing the water to flow away freely from the growing medium, preventing particles wash out thus assuring the flow of redundant water into the drainage system.



DiaDrain-25H Drainage Board. Made of recycled high-impact polystyrene, 25 mm high, compressive strength 322 kN/m2 (unfilled), runoff reference value according to FLL: 0,291, microbiological resistance tested (EN12225), fire resistance classification "BROOF(t2)" (EN13501-5), laid.

Board size (mm):	2020 x 1100 x 25
Rainwater retention capacity (l/sqm)	11,8
Runoff reference value (C):	0,29



Protection Mat. This product protects the roof insulation boards against damage during the installation and future maintenance work serving as a protecting layer.



Root Barrier. Root resistant and vapour control layer made of 20-40 mm thick elastic polyethylene regenerate. Applicable as a vapour control layer and can be used as a root resistant layer on green roofs when lied down with a 1.0 m overlapping. Dimensions: 4x25 m (WxL); Roll width: 1 m; wrapping: 100 m2/roll; colour: black.